

# SUPERIOR ENGINEERED

superiorflooring.ca



## DISCOVER SUPERIOR STRENGTH AND BEAUTY

Superior Engineered floors offer the classic beauty of hardwood with the versatility and strength of an engineered floor. Using a true 11 layer Baltic Birch plywood core and a 4mm hardwood wear layer, our engineered floors are designed to last. Superior Engineered Flooring can be installed on any level of your home or condo and are the perfect solution for environments that challenge traditional solid hardwood floors.

TEXTURE	SHEEN	LEVEL
Smooth	Matte	5%, 10%*
	Low Sheen	25%
	Semi-Gloss	50%
Wirebrushed	Matte	5%, 10%*
Handscraped	Matte	5%, 10%*

\*Matte sheen depends on colour/finish selected.  
Some colours and grades may not be available, please refer to our website or availability charts for available configurations.

### RECOMMENDED MOISTURE CONTENT, RELATIVE HUMIDITY, AND TEMPERATURE RANGE

Temperature		Relative Humidity ( Percent)								
°F	°C	25	30	35	40	50	55	60	65	
50	10	5.5	6.3	7.1	7.9	9.5	10.4	11.3	12.4	
60	15	5.4	6.2	7.0	7.8	9.4	10.2	11.1	12.1	
70	21	5.4	6.2	6.9	7.7	9.2	10.1	11.0	12.0	
80	26	5.3	6.1	6.8	7.6	9.1	9.9	10.8	11.7	
90	32	5.1	5.9	6.7	7.4	8.9	9.7	10.5	11.5	

We do not recommend acclimation of any of our products. Our Engineered hardwood should only be installed in "normal living conditions" 30% to 65% RH. Please consult our warranty and installation guidelines for more information.



#### SPECIES AVAILABLE

Maple  
Hickory  
Ash  
Red Oak  
White Oak



#### BOARD LENGTHS

Random board lengths ranging from 10" to 90"



#### BOARD WIDTHS

5<sup>3</sup>/<sub>16</sub>" | 6" | 7"

#### BOARD THICKNESS

3/4"



#### AVAILABLE GRADES

Premier  
Select  
Heritage



# ENGINEERED INSTALL DETAILS

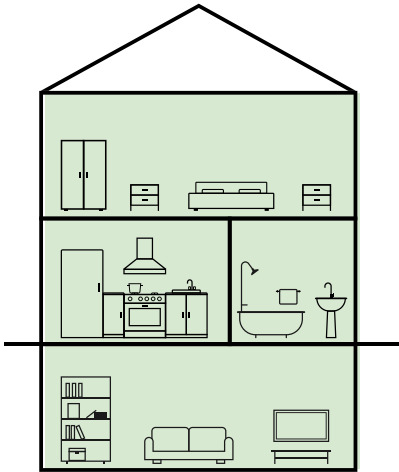

## ACCEPTED INSTALLATION LOCATIONS

- Above Grade
  - On Grade
  - Below Grade
  - Radiant Heat Friendly
- (select species/sizes not recommended see our radiant heat guide.)

### INSTALLATION METHODS

- Cleats, staples, floating, or glue-down.
- Wood subfloors
- Concrete subfloors.

### APPROVED UNDERLAYS

We recommend Silicone impregnated paper (i.e: All Globe) or Laminated Kraft paper and asphalt (i.e: Fortifiber Aquabar B)



## PACKAGING SPECIFICATIONS

PRODUCT DIMENSIONS	SQFT PER BOX	SQFT PER SKID	BOXES PER SKID	LBS PER BOX
5 3/16" (132mm) x 3/4" (19mm)	24.5	1,078	44	65-70
6" (152mm) x 3/4" (19mm)	21.5	645	30	60-65
7" (178mm) x 3/4" (19mm)	25	625	25	65-75

## SUPERIOR'S WATER CLEAR™ FINISH

Our commitment to environmental excellence governs how we finish our products. There are virtually no volatile organic compounds (VOC's) emitted from our Water Clear™ Finish during the application process or afterwards. It is free of formaldehyde, isocyanate or other hazardous air pollutants. Water Clear™ Finish is cured by UV light and is 100% reactive which means that they don't significantly contribute to ground level air pollution.

- ✔ Virtually no VOC's
- ✔ Water based stains
- ✔ Wood absorbs the stain colour which enhances the features of the natural wood
- ✔ Ensures a superior product as any flaws would be apparent in our flooring

INCREDIBLE  
35 YEAR  
FINISH WARRANTY



NORTH  
AMERICAN  
MADE



PROUD MEMBER OF THE  
NATIONAL WOOD FLOORING  
ASSOCIATION

