

# SUPERIOR SOLID



## SOME THINGS NEVER REQUIRE RE-INVENTION

Manufactured from a single piece of hardwood, our solid hardwood flooring is sourced for refined grain, consistent colour and lasting stability. Our solid product-line has become synonymous with excellence and has a reputation of quality that is widely recognized throughout the market. Solid can be used in any room above grade that is not prone to moisture or significant humidity and temperature fluctuations.

TEXTURE	SHEEN	LEVEL
Smooth	Matte	5%, 10%*
	Low Sheen	25%
	Semi-Gloss	50%
Wirebrushed	Matte	5%, 10%*
Handscraped	Matte	5%, 10%*

\*Matte sheen depends on colour/finish selected.  
Some colours and grades may not be available, please refer to our website or availability charts for available configurations.

### RECOMMENDED MOISTURE CONTENT, RELATIVE HUMIDITY, AND TEMPERATURE RANGE

Temperature		Relative Humidity ( Percent)					
°F	°C	25	30	35	40	50	55
50	10	5.5	6.3	7.1	7.9	9.5	10.4
60	15	5.4	6.2	7.0	7.8	9.4	10.2
70	21	5.4	6.2	6.9	7.7	9.2	10.1
80	26	5.3	6.1	6.8	7.6	9.1	9.9
90	32	5.1	5.9	6.7	7.4	8.9	9.7

We do not recommend acclimation of any of our products. Our Solid hardwood should only be installed in "normal living conditions" 35% to 50% RH. Please consult our warranty and installation guidelines for more information.



#### SPECIES AVAILABLE

Maple  
Hickory  
Ash  
Red Oak  
White Oak



#### BOARD LENGTHS

Random board lengths  
ranging from  
10" to 90"



#### BOARD WIDTHS

3 1/4" | 4 1/4"

#### BOARD THICKNESS

3/4"



#### AVAILABLE GRADES

Premier  
Select  
Heritage

# SOLID INSTALL DETAILS

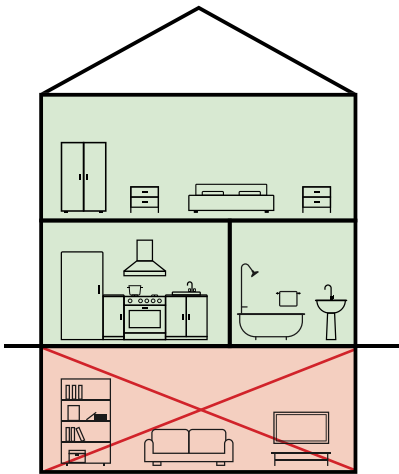

## ACCEPTED INSTALLATION LOCATIONS

- Above Grade
- On Grade
- ⊗ Below Grade
- ⊗ Radiant Heat Friendly

## INSTALLATION METHODS

- Nail (cleat) over wood subfloor
- Glue-down (wood subfloor only)

## APPROVED UNDERLAYS

We recommend Silicone impregnated paper (i.e: **All Globe**) or Laminated Kraft paper and asphalt (i.e: **Fortifiber Aquabar B**)



## PACKAGING SPECIFICATIONS

PRODUCT DIMENSIONS	SQFT PER BOX	SQFT PER SKID	BOXES PER SKID	LBS PER BOX
3 1/4" (83mm) x 3/4" (19mm)	23	1,012	44	60-75
4 1/4" (108mm) x 3/4" (19mm)	20	880	44	55-65

## SUPERIOR'S WATER CLEAR™ FINISH

Our commitment to environmental excellence governs how we finish our products. There are virtually no volatile organic compounds (VOC's) emitted from our Water Clear™ Finish during the application process or afterwards. It is free of formaldehyde, isocyanate or other hazardous air pollutants. Water Clear™ Finish is cured by UV light and is 100% reactive which means that they don't significantly contribute to ground level air pollution.

- ✔ Virtually no VOC's
- ✔ Water based stains
- ✔ Wood absorbs the stain colour which enhances the features of the natural wood
- ✔ Ensures a superior product as any flaws would be apparent in our flooring

INCREDIBLE  
35 YEAR  
FINISH WARRANTY



NORTH  
AMERICAN  
MADE



PROUD MEMBER OF THE  
NATIONAL WOOD FLOORING  
ASSOCIATION

